

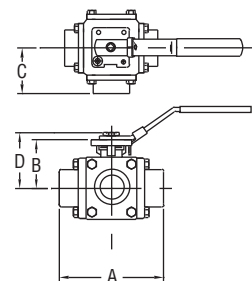

## Series 3BV3H 3-Way Stainless Steel Ball Valve

### Specifications - Installation and Operating Instructions



Dimensions (in)

Model	NPT Size	ISO 5211	A	B	C	D	Weight lb (kg)
3BV3HX02	1/2"	F03/04	3.78	1.96	1.89	2.26	3.90 (1.77)
3BV3HX03	3/4"	F04/05	4.21	2.35	2.11	2.72	5.65 (2.56)
3BV3HX04	1"	F04/05	4.96	2.50	2.48	2.93	8.85 (4.01)
3BV3HX05	1-1/4"	F05/07	5.24	3.13	2.62	3.78	11.90 (5.40)
3BV3HX06	1-1/2"	F05/07	5.94	3.40	2.97	4.07	18.45 (8.37)
3BV3HX07	2"	F07/10	6.54	4.13	3.27	4.80	23.25 (10.55)

The Series 3BV3H 3-Way Stainless Steel Ball Valve incorporates heavy duty construction with a full port design. Ball and stem are manufactured of high quality 316 SS. The 4-seat design is excellent for high cycle applications. Pneumatic and electric actuators can be easily mounted using the ISO 5211 mounting pad. The Series 3BV3H offers 1/2 to 2" providing exceptional flow rates, minimizing pressure loss.

#### OPERATIONS

**Manual Operations-**To open or close the valve, turn the handle 90° (1/4 turn). Valve in position 1: the handle is parallel (in line) with the valve pipeline. Valve in position 2: the handle is perpendicular (crossed) with the valve or pipeline.

**Automated Operation-**Valves with actuators should be checked for stem alignment. Most applications are direct mount to the actuator, greatly reducing any sideload or increased torque. Make sure that all insert adapters are properly placed on the valve stem and fully engaged in the actuator.

#### INSTALLATION

**General Information for On-Site Installation-**The valve may be fitted in any position in the pipeline. For automated operation, W.E. Anderson recommends that the valve and actuator be installed vertically in case of valve leakage, although this is not necessary for proper operation of the valve. Prior to installation, inspect valve and pipe ends to make sure they are free from debris. Materials trapped inside the valve can cause damage to the seats and result in leakage. Clean pipe ends and check for proper threading to prevent damage to valve internals. Use a PTFE based thread sealant applied to the pipe threads. Use a smooth wrench on the hex portion of the valve, not the valve body, to tighten. Use pipe wrenches on pipe and pipe fittings only.

#### SPECIFICATIONS

**Service:** Compatible liquids and gases.

**Line Size:** 1/2 to 2".

**End Connection:** Female NPT.

**Pressure Limit:** 1000 psi (69 bar).

**Wetted Materials:**

Body and ends: CF8M;

Ball and stem: 316 SS;

Seats: RTFE.

**Temperature Limit:** 450°F (232°C).

**Other Materials:**

Packing gland, belleville washer, spring washer, body bolts, and packing nut: 304 SS;

Blank cap: 316 SS;

Body seal, stem packing, and thrust washer: PTFE.

#### WARRANTY

The Series 3BV3H warranties from defects in materials and workmanship are covered for (1) year from the date of purchase. In the unlikely event the valve should fail, the unit can be returned to the factory for warranty repair if the warranty period has not expired. Be sure to include a brief description of the problem plus any relevant application notes. Contact our customer service department for an RGA number and to set up the return.