

CONNECTION TYPE	INLET/OUTLET SIZE	ORIFICE		A	B	C	D	E	F						
		IN [MM]	[MM]							IN [MM]	[MM]	IN [MM]	[MM]	IN [MM]	[MM]
FRACTIONAL TUBE FITTING	1/8"	3/32	2.36	2	50.5	63/64	24.9	15/32	11.7	3/8	9.4	1-41/64	41.7	2	50.4
	1/4"	11/64	4.37	2-11/64	55.1	1-5/64	27.4	15/32	11.7	3/8	9.4	1-41/64	41.7	2	50.4
	3/8"	11/64	4.37	2-19/64	58.2	1-9/64	29.0	15/32	11.7	3/8	9.4	1-41/64	41.7	2	50.4
	3/8"	9/32	7.19	2-21/32	67.6	1-21/64	33.8	21/32	16.8	9/16	14.2	2-3/16	55.4	2-5/8	66.8
FEMALE NPT	1/2"	9/32	7.19	2-35/64	64.8	1-7/16	36.6	21/32	16.8	9/16	14.2	2-3/16	55.4	2-5/8	66.8
	1/8"	11/64	4.37	1-25/32	45.2	57/64	22.6	15/32	11.7	3/8	9.4	1-41/64	41.7	2	50.4
	1/4"	11/64	4.37	2-3/32	53.1	1-3/64	26.7	15/32	11.7	3/8	9.4	1-41/64	41.7	2	50.4
	1/4"	9/32	7.19	2-3/8	60.5	1-3/16	30.2	21/32	16.8	9/16	14.2	2-3/16	55.4	2-5/8	66.8
	1/2"	9/32	7.19	2-7/8	73.2	1-7/16	36.6	21/32	16.8	9/16	14.2	2-3/16	55.4	2-5/8	66.8

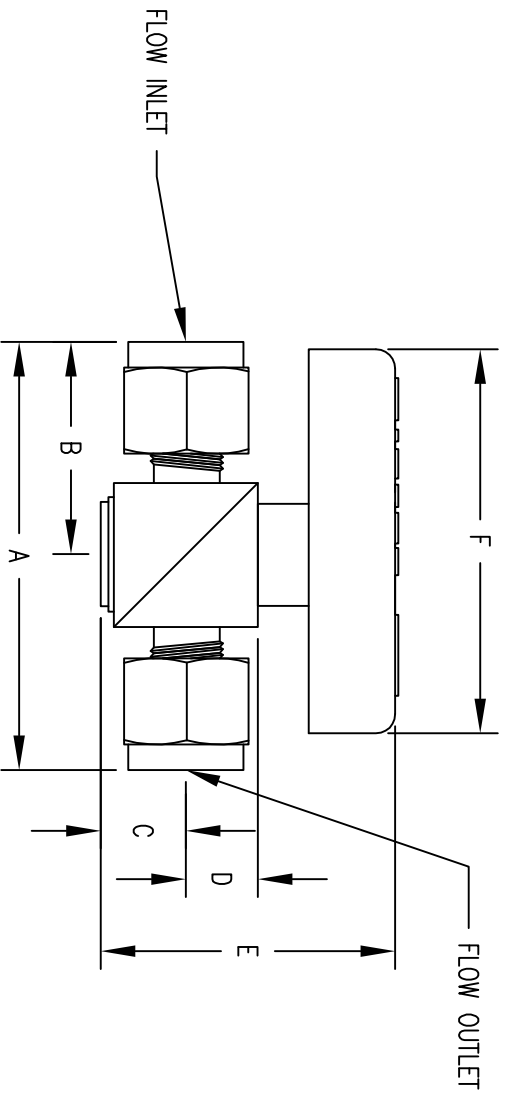
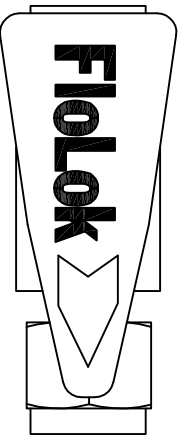

Ⓢ = CRITICAL DIMENSION  
 STANDARD TOLERANCES UNLESS NOTED:  
 ALL DECIMAL DIMENSIONS ± .005  
 ALL ANGLES ± 1°

DATE		NAME		MATERIAL	
DWN BY		PGV SERIES		FINISH	
CHKD		COMPACT		Dwyer Instruments, Inc.	
APPD		PLUG VALVE		MICHIGAN CITY, INDIANA 46360 U.S.A.	
BY/DATE		ACAD2002		FR. NO.	
CHANGES		3			

NOTICE: This drawing and the principles and elements of design embodied therein are the exclusive property of DWYER INSTRUMENTS, INC. and are not to be communicated, disclosed, reproduced or used except as previously authorized in writing by such corporation and must not be submitted to outside parties for examination without the written consent of said corporation.